

The Cargo Building

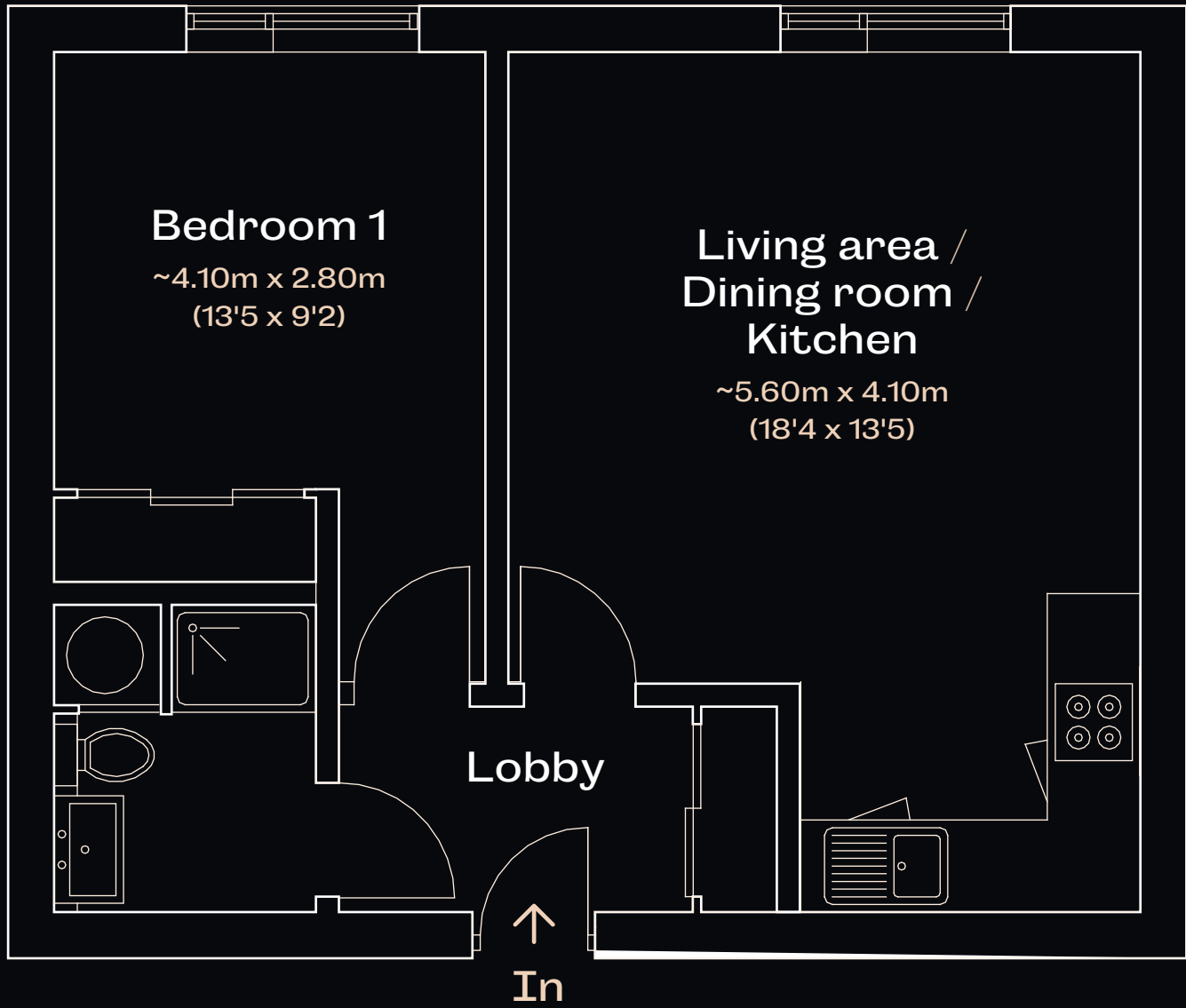

Approximate gross internal area
474 sq. ft. (44 sq. m.)

This plan is indicative of the types of property within
this development (including mirros image layouts)

This plan is for layout guidance only. Not drawn to scale
unless stated. Windows and door openings are
approximate. Whilst every care is taken in the
preparation of this plan, please check all dimensions,
shapes and compass bearings before making any
decisions reliant upon them. Please be advised that The
Cargo Building team / our agents have not seen or
reviewed any building regulations or planning permission
in relation to works carried out to the property
(ID324247)