

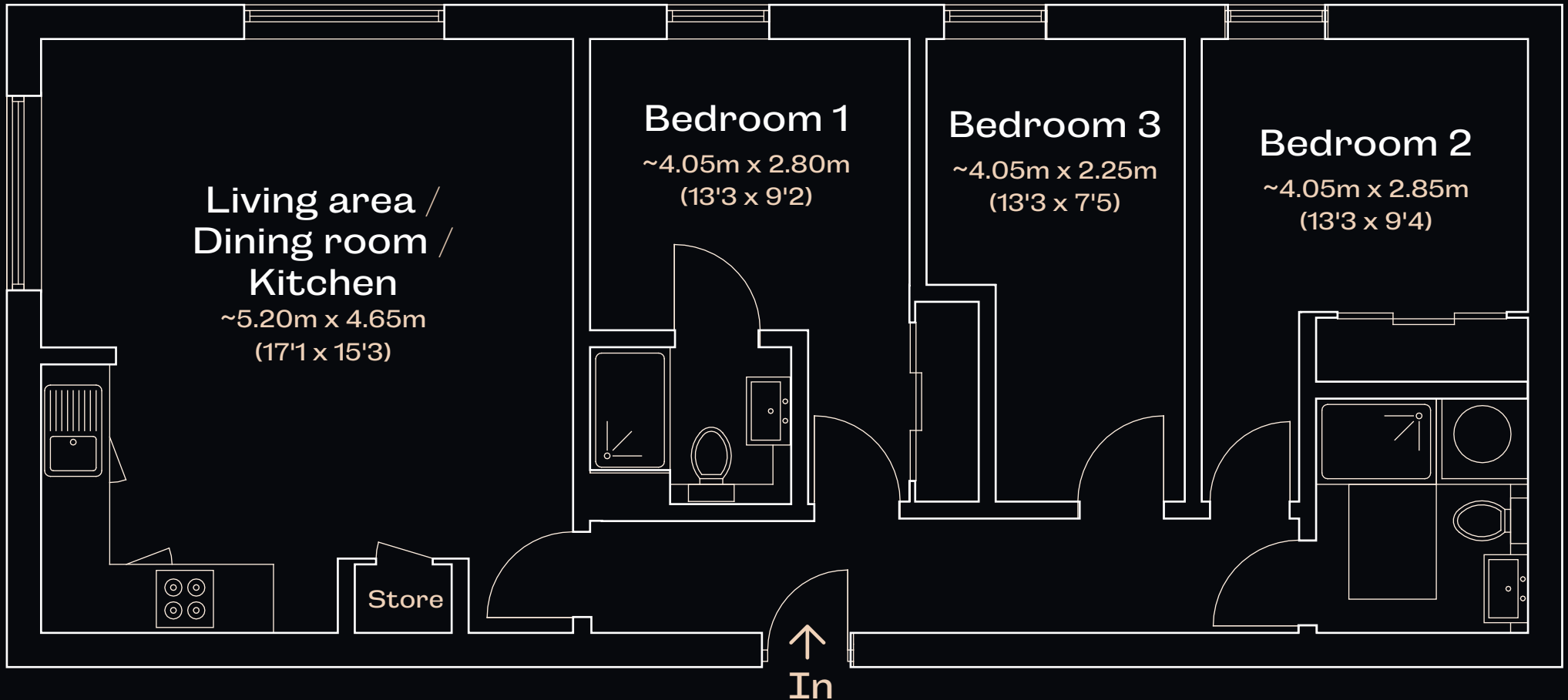

# The Cargo Building



**Approximate gross  
internal area  
770 sq. ft. (71.5 sq. m.)**

2.40m / 7'9 = (minimum) ceiling height

This plan is indicative of the types of  
property within this development (including  
mirros image layouts)

Please note ceiling height may vary

This plan is for layout guidance only. Not drawn to scale unless stated.  
Windows and door openings are approximate. Whilst every care is taken in  
the preparation of this plan, please check all dimensions, shapes and  
compass bearings before making any decisions reliant upon them. Please  
be advised that The Cargo Building team / our agents have not seen or  
reviewed any building regulations or planning permission in relation to  
works carried out to the property (ID324272)